

Owner's Guide

Important Safety Instructions

WARNING: To reduce the risk of fire or electrical shock, do not expose your Acoustic Wave® music system to rain or moisture. The apparatus shall not be exposed to dripping or splashing, and objects filled with liquids, such as vases, shall not be placed on the apparatus.



WARNING: As with any electronic product, use care not to spill liquids into any part of the system. Liquids can cause a failure and/or a fire hazard.

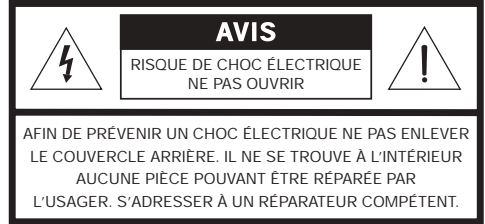
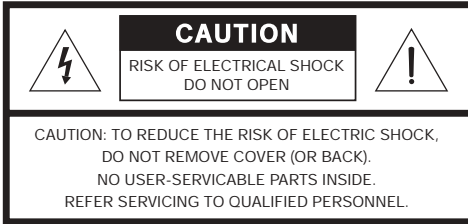

These CAUTION marks appear on your Acoustic Wave® music system.



The lightning flash with arrowhead symbol within an equilateral triangle is intended to alert the user to the presence of uninsulated dangerous voltage within the system enclosure that may be of sufficient magnitude to constitute a risk of electrical shock.



The exclamation point within an equilateral triangle, as marked on the system, is intended to alert the user to the presence of important operating and maintenance instructions in this owner's guide.

CAUTION: For units with a polarized power plug, to prevent electric shock, match wide blade of plug to wide slot, insert fully.

WARNING: The Acoustic Wave® music system may be used with the UL Listed Bose Acoustic Wave® music system pedestal only. Using your system with other stands may result in instability causing possible injury. For ordering information see your Owner's Kit.

Use of controls or adjustments or performance of procedures other than those specified herein may result in hazardous radiation exposure. The compact disc player should not be adjusted or repaired by anyone except properly qualified service personnel.

A severe shock hazard exists if the Acoustic Wave® music system falls into water while plugged in. Use battery power when operating near water.

CAUTION: Using an adapter other than the UL Listed Bose® 12V DC power cord can damage your system. For ordering information see your Owner's Kit.

When using the Acoustic Wave® music system in a mobile environment such as an automobile, recreational vehicle or boat, be sure that it is secured to prevent accidental movement.

Do not place your system near recorded materials such as audio or video tapes, computer discs, and credit or bank cards. It may erase them.

Be sure the system has enough ventilation.

Class 1 Laser Product

This CD player is classified as a CLASS 1 LASER PRODUCT according to EN 60825-1:1994 + A11. The CLASS 1 LASER PRODUCT label is located on the back of the system.

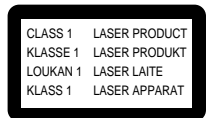

Batteries

Please dispose of used batteries properly, following any local regulations. Do not incinerate.

WARNING: No naked flame sources, such as lighted candles, should be placed on the apparatus.

- 1. Read these instructions** – for all components before using this product.
- 2. Keep these instructions** – for future reference.
- 3. Heed all warnings** – on the product and in the owner's guide.
- 4. Follow all instructions.**
- 5. Do not use this apparatus near water or moisture** – Do not use this product near a bathtub, washbowl, kitchen sink, laundry tub, in a wet basement, near a swimming pool, or anywhere else that water or moisture are present.
- 6. Clean only with a dry cloth** – and as directed by Bose® Corporation. Unplug this product from the wall outlet before cleaning.
- 7. Do not block any ventilation openings. Install in accordance with the manufacturer's instructions** – To ensure reliable operation of the product and to protect it from overheating, put the product in a position and location that will not interfere with its proper ventilation. For example, do not place the product on a bed, sofa, or similar surface that may block the ventilation openings. Do not put it in a built-in system, such as a bookcase or a cabinet that may keep air from flowing through its ventilation openings.
- 8. Do not install near any heat sources, such as radiators, heat registers, stoves or other apparatus (including amplifiers) that produce heat.**
- 9. Do not defeat the safety purpose of the polarized or grounding-type plug. A polarized plug has two blades with one wider than the other. A grounding-type plug has two blades and a third grounding prong. The wider blade or third prong are provided for your safety. If the provided plug does not fit in your outlet, consult an electrician for replacement of the obsolete outlet.**
- 10. Protect the power cord from being walked on or pinched, particularly at plugs, convenience receptacles, and the point where they exit from the apparatus.**
- 11. Only use attachments/accessories specified by the manufacturer.**
- 12. Use only with the cart, stand, tripod, bracket or table specified by the manufacturer or sold with the apparatus. When a cart is used, use caution when moving the cart/apparatus combination to avoid injury from tip-over.**
- 13. Unplug this apparatus during lightning storms or when unused for long periods of time** – to prevent damage to this product.
- 14. Refer all servicing to qualified service personnel. Servicing is required when the apparatus has been damaged in any way: such as power-supply cord or plug is damaged; liquid has been spilled or objects have fallen into the apparatus; the apparatus has been exposed to rain or moisture, does not operate normally, or has been dropped** – Do not attempt to service this product yourself. Opening or removing covers may expose you to dangerous voltages or other hazards. Please call Bose to be referred to an authorized service center near you.
- 15. To prevent risk of fire or electric shock, avoid overloading wall outlets, extension cords, or integral convenience receptacles.**
- 16. Do not let objects or liquids enter the product** – as they may touch dangerous voltage points or short-out parts that could result in a fire or electric shock.
- 17. See product enclosure for safety related markings.**

Information about products that generate electrical noise

This equipment has been tested and found to comply with the limits for a Class B digital device, pursuant to Part 15 of the FCC rules. These limits are designed to provide reasonable protection against harmful interference in a residential installation. This equipment generates, uses, and can radiate radio frequency energy and, if not installed and used in accordance with the instructions, may cause harmful interference to radio communications. However, this is no guarantee that interference will not occur in a particular installation. If this equipment does cause harmful interference to radio or television reception, which can be determined by turning the equipment off and on, you are encouraged to try to correct the interference by one or more of the following measures:

- Reorient or relocate the receiving antenna.
- Increase the separation between the equipment and receiver.
- Connect the equipment to an outlet on a different circuit than the one to which the receiver is connected.
- Consult the dealer or an experienced radio/TV technician for help.

Note: Unauthorized modification of the receiver or radio remote control could void the user's authority to operate this equipment.

This product complies with the Canadian ICES-003 Class B specifications.



18. Use Proper Power Sources – Plug the product into a proper power source, as described in the operating instructions or as marked on the product.

19. Avoid Power Lines – Use extreme care when installing an outside antenna system to keep from touching power lines or circuits, as contact with them may be fatal. Do not install external antennas near overhead power lines or other electric light or power circuits, nor where an antenna can fall into such circuits or power lines.

20. Ground All Outdoor Antennas – If an external antenna or cable system is connected to this product, be sure the antenna or cable system is grounded. This will provide some protection against voltage surges and built-up static charges.

Section 810 of the National Electrical Code ANSI/NFPA No. 70 provides information with respect to proper grounding of the mast and supporting structure, grounding of the lead-in wire to an antenna discharge unit, size of grounding conductors, location of antenna-discharge unit, connection to grounding electrodes, and requirements for the ground electrode. Refer to the antenna grounding illustration on this page.

Antenna grounding

Example of antenna grounding as per National Electrical Code, ANSI/NFPA 70.

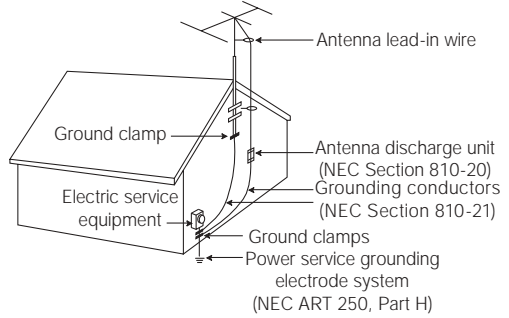

Note to CATV system installer

This reminder is provided to call the CATV system installer's attention to Article 820-40 of the NEC (of USA) that provides guidelines for proper grounding. In particular, it specifies that the cable ground shall be connected to the grounding system of the building, as close to the point of cable entry as is practical.

Where to find ...

Setting Up Your Acoustic Wave® Music System	4
Before you begin	4
Unpacking the carton	5
Selecting a location for your music system	6
Installing the remote control battery	6
Connecting the power cord	7
Choosing an FM antenna	7
Operating Your Acoustic Wave® Music System	8
Operating with the remote control	8
Operating with the control panel	9
Controlling the system	10
Operating on battery power	10
Listening to the radio	11
Using the CD player	12
Listening to a component connected to AUX	13
Using External Components	14
Connecting external components to the system	14
Using a CD player, VCR, tape deck, or TV	14
Using a turntable	14
Using the system as expansion speakers	15
Using the Bose® powered microphone	15
Maintaining Your Acoustic Wave® Music System	16
Taking care of your Acoustic Wave® music system	16
Technical information	16
Troubleshooting	17
Customer service	17
Limited warranty	18
Bose Corporation	Inside back cover

For your records

The serial number is located on the back of your system.

System serial number: _____

Purchase date: _____

We suggest you keep your sales receipt together with this owner's guide.

Please read this owner's guide

Please take the time to follow this owner's guide carefully. It will help you set up and operate your system properly, and enjoy all of its features. Save your owner's guide for future reference.

Before you begin

Thank you for purchasing the Bose® Acoustic Wave® music system. Engineered to be the finest compact sound system you've ever heard, it produces lifelike tones and full bass with true clarity.

The benefits of exclusive Bose technologies help the Acoustic Wave® music system exceed all your musical expectations. Our award-winning acoustic waveguide speaker technology produces full, clear stereo sound by guiding air through a labyrinth air chamber. Proprietary circuitry automatically adjusts the tonal balance so that you hear natural sound at all volume levels. This means that you can hear full, realistic bass at all volume levels.

Your Acoustic Wave® music system includes:

- Integrated system design for high acoustic quality and ease of use.
- A high-performance AM/FM tuner with 5 AM and 5 FM station presets.
- Full-function CD player.
- Credit card-size remote.
- Molded inset handles for easy carrying.

Optional accessories available through Bose include:

- Pedestal – Add up to four listening options to your system with inputs for your VCR, TV, tape deck or other source. Plug them all into the pedestal and sit back and relax.
- Travel Case – Provides a convenient, safe and attractive way to take the music with you. This durable case has a handy pocket. It's also water resistant and machine washable.
- Power Case – Plug your system into the hidden battery compartment in this padded case to enjoy 8 to 10 hours of portable entertainment (D-cell batteries not included).
- Power Pack – This rechargeable, portable power system fits neatly into the Power Case for 10 to 12 hours of play time. Includes a 12V DC battery, power cord, and charger.
- Power Microphone – To sing along with the music or make announcements, use this battery powered microphone to create a mini PA system (AA batteries included).
- Power Cord – Enjoy your favorite music anywhere you go. A DC adapter connects your system to any standard vehicle cigarette lighter for lifelike sound in your car, boat or RV.

To order any accessory, call Bose Customer Service. See the inside back cover for telephone listings.

Unpacking the carton

Carefully unpack your music system. Save all packing materials for possible future use. The original packing materials provide the safest way to transport your Acoustic Wave® music system. If any part of the product appears damaged, do not attempt to use it. Notify Bose® Customer Service immediately (see phone numbers on the inside back cover).

Check to be sure you received the parts identified in Figure 1.

♪ *Note: Find the serial number on the back of your music system. Write it in the space provided on page 3.*

Figure 1

Contents of the shipping carton

- Acoustic Wave® music system
- Remote control
- Power cord
- Stereo audio cable
- Owner's kit

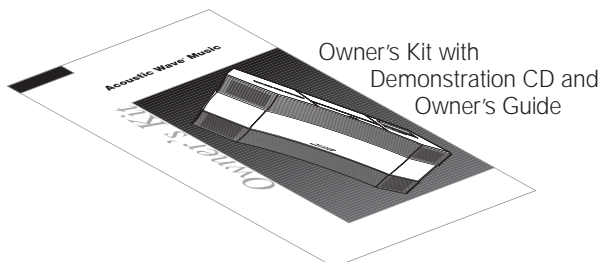
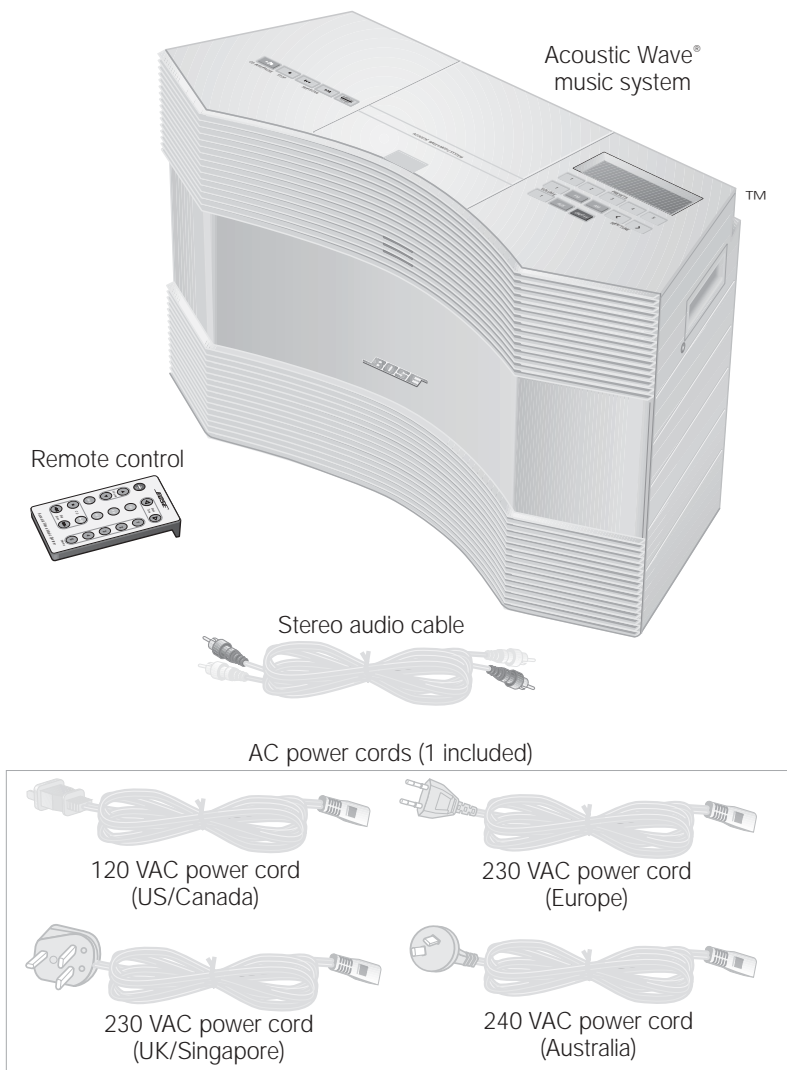

Selecting a location for your music system

As with any high-performance sound system, the tonal quality of your Acoustic Wave® music system will vary with room placement. Feel free to experiment, but keep in mind that this system was designed to sound best when placed on a shelf, counter, desk, or table top, 30 to 48 inches (75 - 120 cm) from the floor. It should be near the center of a wall and 6 inches (15 cm), or less, away from the wall. To increase bass response, move the unit toward any corner of the room; to decrease bass response, move it away from the corner.

Installing the remote control battery

Your remote control battery may already be installed. If you need to install or replace the battery follow the instructions below:

Your remote control may be one of two types (figure 2A or 2B). Each is identified by the way the battery compartment unlocks.

1. Place the remote control face down on a flat surface.
2. If your remote has a slot on the back (Figure 2A), follow step A. Otherwise, follow step B and refer to Figure 2B:
 - A. Insert the tip of a ballpoint pen into the slot. Push to the side as shown and hold. Slide the battery compartment open with your finger (and, if necessary, remove the battery).
 - B. Using your finger, push the tab lock to the side as shown and hold. Slide the battery compartment open (and, if necessary, remove the battery).

Figure 2A and B

Installing the battery

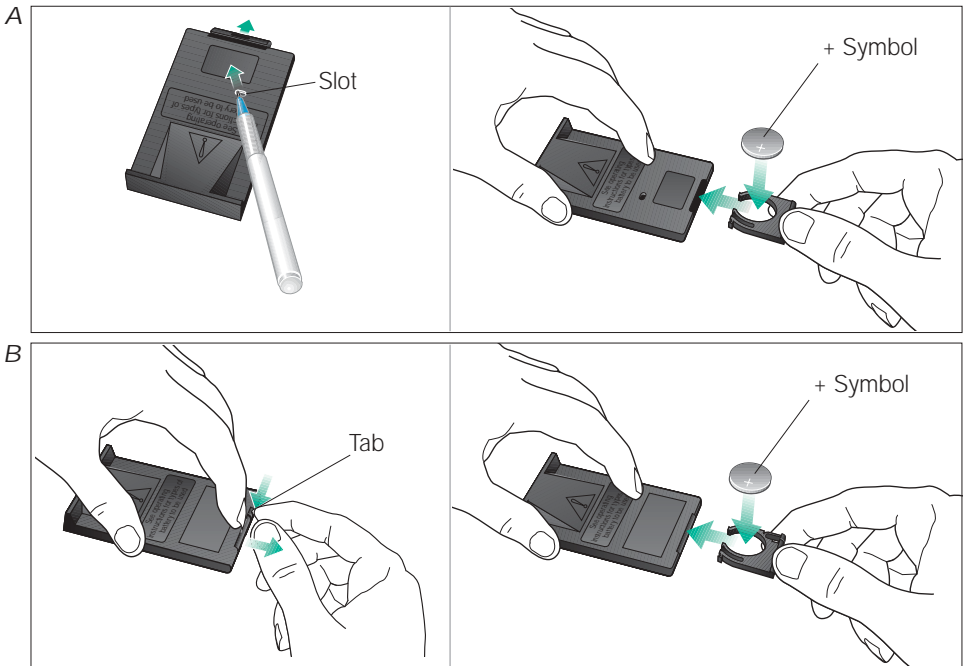

3. Keeping the remote control face down, insert the new battery into the compartment with the + symbol facing up.
4. Gently slide the battery compartment closed. It locks automatically.



CAUTION: Danger of explosion if battery is incorrectly replaced. Replace only with the same or equivalent type.

⚠ WARNING: Mishandling the remote control battery may cause a fire or chemical burn. Keep the battery away from children.

Do not recharge, disassemble, heat above 212°F (100°C), or incinerate the battery. Dispose of the used battery promptly and responsibly.

Replace only with a lithium CR2032 or DL2032 battery by Duracell, Eveready, Hitachi, Maxell, or Toshiba (available from most electronics stores). Other batteries are not UL approved and may cause a fire or explosion.

For more information, call the customer service number inside the back cover of this guide.

Connecting the power cord

⚠ CAUTION: Bose recommends using a quality surge suppressor on all electronic equipment. Voltage variations and spikes can damage electronic components in any system. A quality suppressor, which can eliminate the vast majority of failures attributed to surges, may be purchased at electronic stores.

1. Plug the small end of the power cord into the power jack on the back of your Acoustic Wave® music system (Figure 3).
2. Plug the other end of the power cord into an AC power (mains) outlet.

Figure 3

Connecting the power cord at the rear panel

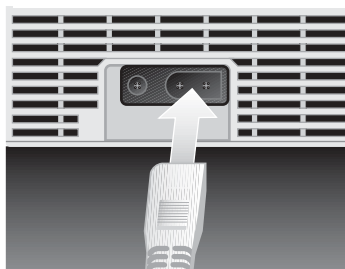

Choosing an FM antenna

The system has an FM ANTENNA SELECT switch located on the back of the unit (Figure 4). The switch should be in the right hand position to select the telescoping antenna. You may choose to connect an external FM antenna, if needed, to the EXTERNAL 75 OHM antenna jack. To use an external FM antenna, slide the switch to the left hand position.

Figure 4

The FM antenna selection switch

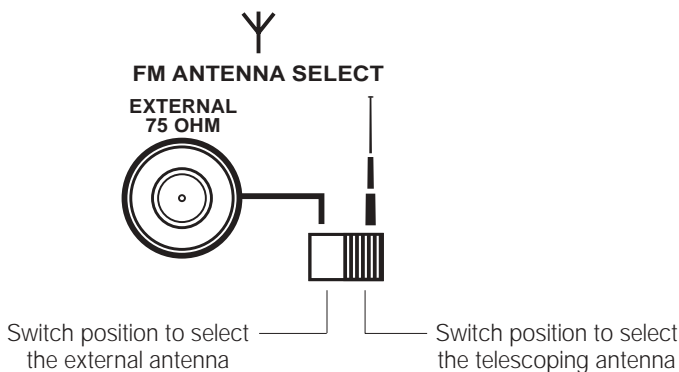

Operating with the remote control

You can use the remote control (Figure 5) to operate most functions of your Acoustic Wave® music system. For CD repeat and random play modes, however, you need to use the *CD Mode* button on the system control panel.

If the remote stops operating, or its range seems reduced, try replacing the battery. However, keep in mind that lighting and other room conditions, in addition to battery age, can affect the operating range of an infrared remote control.

🎵 *Note: The remote control feature does not work when operating your Acoustic Wave® music system on battery power. This function is disabled to conserve battery power. See "Operating on battery power" on page 10.*

Figure 5

The Acoustic Wave® music system remote control

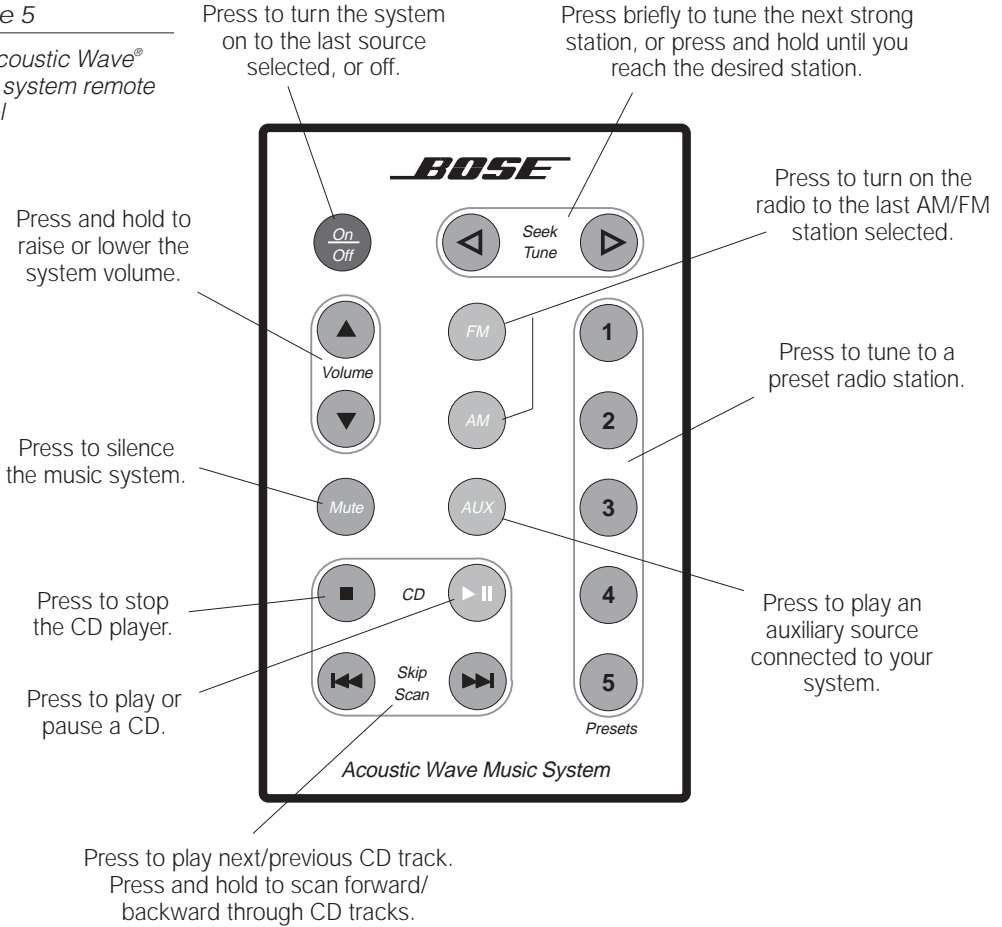

Operating with the control panel

The control panel (Figure 6) has all the same keys as the remote control except that instead of the *Mute* button, the control panel has a *CD Mode* button to select CD random and repeat play modes.

Figure 6

The Acoustic Wave® music system control panel

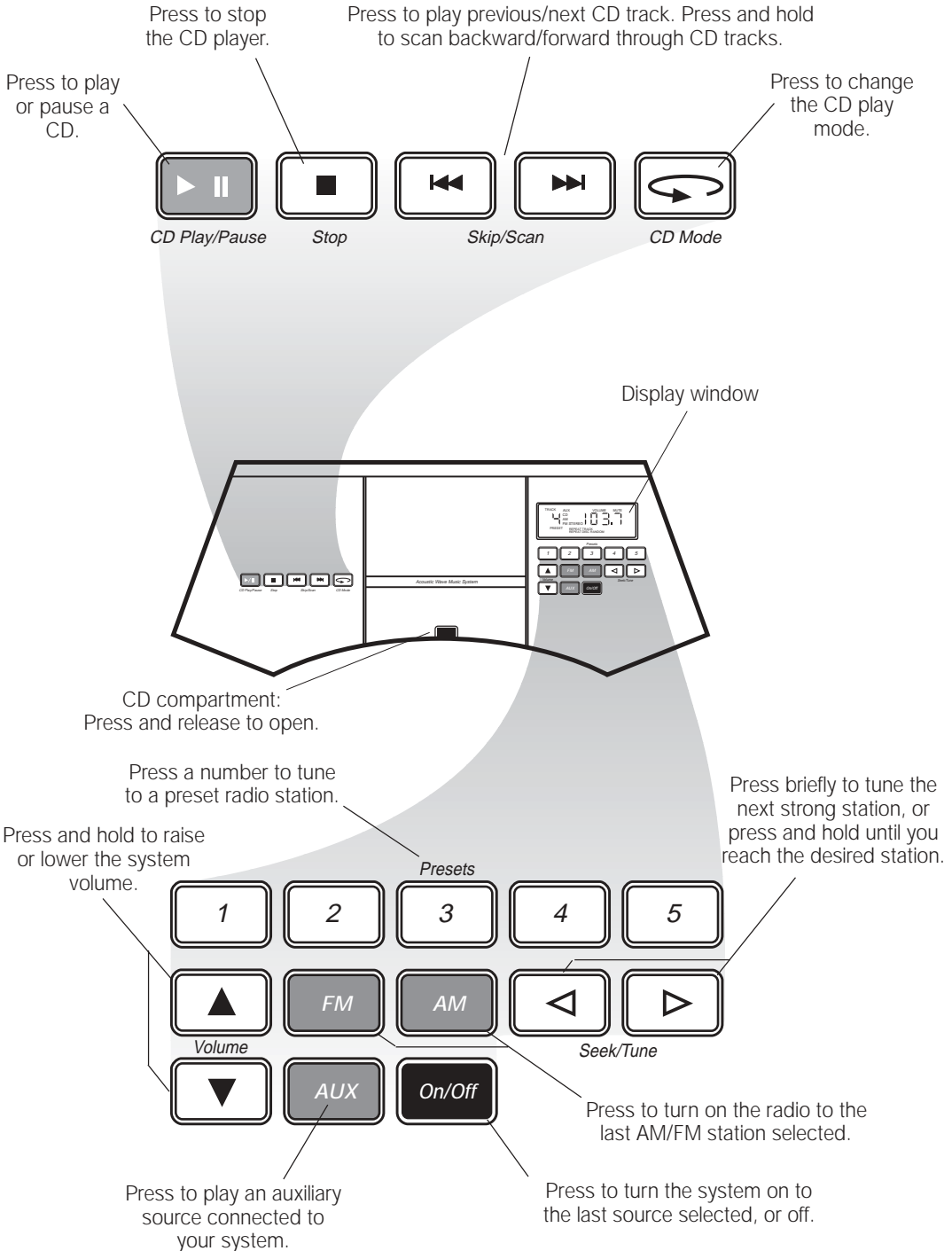

Controlling the system





Function	Control panel	Remote control
<p>To turn the system on and off - Pressing the <i>On/Off</i> button on either the remote or control panel, turns the system on to the source last selected. The display window on the top panel of the system identifies the source. To select a source (<i>FM, AM, CD, or AUX</i>) and turn the system on at the same time, press the button for that source. The display window confirms your selection.</p>		
<p>To adjust the volume level - Press the <i>Volume ▲</i> or <i>Volume ▼</i> button to change the system volume. When you press either <i>Volume</i> button, the display changes to show a numerical value for the volume (Figure 7). The selected volume stays the same when switching from one source to another.</p>		
<p>To mute the system - Using the remote control only, press the <i>Mute</i> button to silence the system. Press again to restore the volume.</p>	<p>Function available only on the remote control.</p>	

Figure 7

VOLUME level indicator

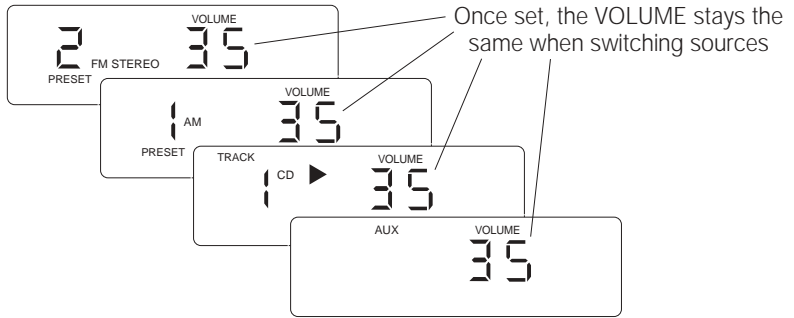

Operating on battery power

When operating on battery power, your music system automatically uses its energy-saving features to extend the life of your batteries:

- The display window does not light. To light the display window briefly, press any button on the control panel.
- The system does not respond to remote control commands.
- The CD player shuts off after a CD plays 3 times in REPEAT DISC or REPEAT DISC RANDOM mode, or after a track plays 8 times in REPEAT TRACK mode.

Listening to the radio

Function

To select FM or AM and turn the system on - If the system is off, press FM or AM to select the radio band and turn the system on. If the system is on, press FM or AM to select either one of these sources. When the radio is on, the display (Figure 8) shows the FM or AM source indicator. If you are tuned to an FM stereo station, the STEREO indicator should also appear.

To automatically seek or manually tune a station - The radio is normally in the *Seek* mode. Briefly press *Seek/Tune* backward ◀ or forward ▶ to automatically tune to the next strongest station. To manually tune to a station, press and hold either *Seek/Tune* button until you reach the station you want. If no button is pressed for two seconds, the system returns to the automatic *Seek* mode.

To set and select preset stations - You can set up to 5 AM and 5 FM preset stations. First, tune to the desired station. Then press and hold any preset button. The system mutes the volume while the preset is being stored. When the volume returns the operation is done.

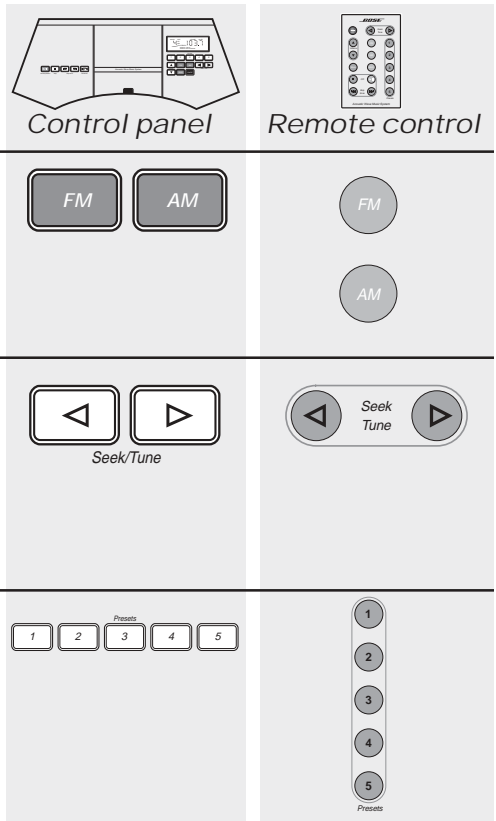

Adjusting the AM antenna

You can adjust the AM antenna by turning your music system slightly. AM antennas are particularly susceptible to electrical interference. You can improve reception by moving the system away from sources of interference such as home appliances, televisions, dimmer switches, and incandescent or fluorescent lights.

Adjusting the FM antenna

The FM ANTENNA SELECT switch on the back of the system should be in the right hand position to select the telescoping FM antenna. Adjust the telescoping antenna for best FM performance. To use an external FM antenna, move the switch to the left hand position.

Figure 8

The radio display

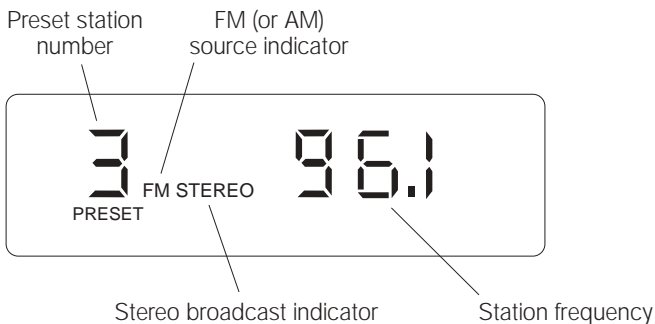

Using the CD player

Press the tab on the top of the CD compartment cover and release to open (Figure 9). Insert a CD, label side up, into the player. Push the cover down to close it. If the system is on when you load a disc, the display briefly shows the total play time on the CD (Figure 10) and the CD begins to play.

Figure 9

Loading a CD

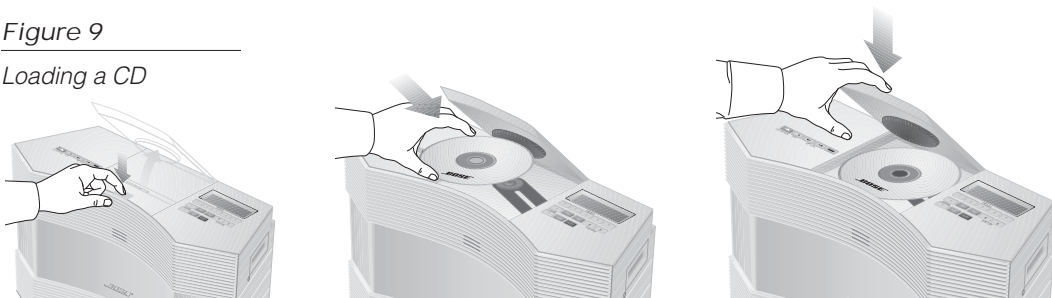

Function



Control panel



Remote control

To select the CD player and turn on the system - If the system is off, load a CD into the compartment and press the *CD Play/Pause* ►|| button to select the CD player and turn on the system. If the system is on, press *CD Play/Pause* ►|| to select this source.



CD Play/Pause



To play or pause the CD - Press *CD Play/Pause* ►||. The CD starts playing and the display briefly shows the total number of tracks on the CD and the total playing time (Figure 10). If there is no CD in the compartment, the word "DISC" flashes on the display. If there is a disc, the display shows the current track playing and elapsed play time. While a CD is playing, press *CD Play/Pause* ►|| to pause the CD. Press *CD Play/Pause* ►|| again to resume play.



CD Play/Pause



To stop the CD - Press *Stop* ■. In the display window, the track number and elapsed time both return to zero.



Stop



To skip/scan through a CD - Press the *Skip/Scan* backward ◀◀ or forward ▶▶ button to play the next or previous track. The display shows the new track number and elapsed time. Press and hold the backward ◀◀ or forward ▶▶ button to scan through a CD. Continue holding to scan the next or previous track(s).



Skip/Scan



To change the play mode - Press the *CD Mode* button to select a repeat/random play mode:

- **RANDOM** – plays all tracks in random order.
- **REPEAT DISC RANDOM** – continuously plays all tracks in random order until stopped.
- **REPEAT DISC** – plays the CD continuously until stopped.
- **REPEAT TRACK** – plays the current track continuously until stopped.



CD Mode

Function available only on the control panel.

Function

To view number of tracks and total play time -
 Press *Stop* ■ and then press *CD Play/Pause* ►||.
 The display momentarily shows the total number of tracks and playing time of a CD.

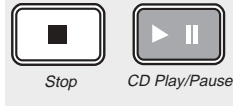
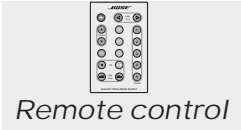
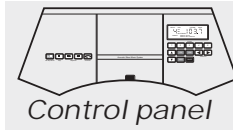

To automatically play the radio when a CD ends -
 Select the desired radio station. Press and hold the *CD Play/Pause* ►|| button. While holding the *CD Play/Pause* button ►||, press and release the AM or FM button. The display flashes AM or FM to confirm your choice.



Figure 10
 The CD display

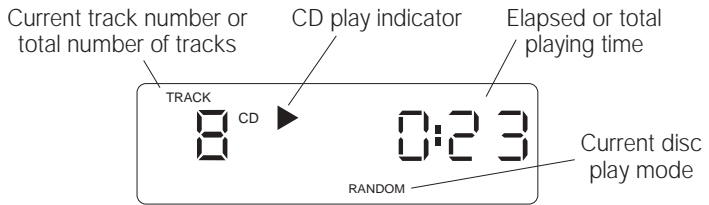

Note: To prolong laser life, the CD player automatically turns off after 8 hours of continuous play. Also, if a CD is left unattended in pause mode, the system automatically turns off after 30 minutes.

Listening to a component connected to AUX

You can use your Acoustic Wave® music system to produce room-filling sound from an external source connected to the rear panel AUX inputs. See "Connecting external components to the system" on page 14 for information on connecting other sources.

1. Turn on the external source.
2. Press the AUX button on the Acoustic Wave® system to select the source and turn on the system. If the system is already on, just press AUX. The display should show "AUX" and the VOLUME level (Figure 11).
3. Adjust the volume of the source using the *Volume* ▲ or ▼ buttons. Control all other source functions at the external component. If necessary, refer to the owner's guide for the external component.

Figure 11
 The AUX display

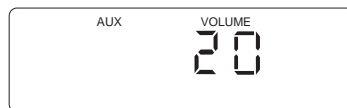

Connecting external components to the system

You can connect other components to the rear panel of your Acoustic Wave® system (Figure 12).



CAUTION: Turn off the power to the system and any component being installed before making connections.

Figure 12

Rear panel input/
output connections

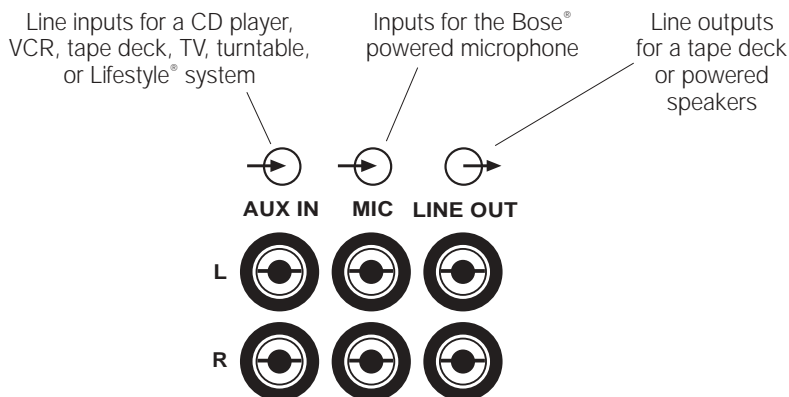

Using a CD player, VCR, tape deck, or TV

1. Plug one end of the stereo audio cable supplied with your Acoustic Wave® music system into the output jacks of the component.
2. Plug the other end of the cable into the AUX IN jacks of your music system.
3. Press the AUX button to select the external component.

♪ *Note:* If the component has a mono output, use a Y-adapter cable to connect the single mono output of the component to the stereo audio cable. If you need help finding a Y-adapter cable, call the customer service number inside the back cover.

♪ *Note:* To prevent interference with the screen image, keep the music system at least one foot (30 cm) from a television or computer monitor.

Using a turntable

To connect a turntable, you need a phono preamplifier with RIAA equalization.

1. Plug the turntable cable into the preamplifier.
2. Plug one end of the stereo audio cable supplied with your Acoustic Wave® music system into the output jacks of the preamplifier. Match the red plug to R (right) and black or white plug to L (left).
3. Plug the other end of the stereo cable into the AUX IN jacks of your music system. Match the red plug to R (right) and black or white plug to L (left).
4. Press the AUX button to select the turntable.

Using the system as expansion speakers

You can use your Acoustic Wave® music system as expansion speakers for a Lifestyle® music system. To do this, connect the output of the Lifestyle® music system to the AUX IN jacks of your Acoustic Wave® music system. Refer to the owner's guide for your Lifestyle® system for wiring information.

Using the Bose® powered microphone

Follow the instructions for your Bose powered microphone to connect to the MIC jacks. This allows you to mix the microphone with any selected source.

- For public address, select *AUX*.
- For karaoke, insert a CD and press *CD Play/Pause*. The CD plays while you sing along.

Taking care of your Acoustic Wave® music system

The only necessary maintenance is cleaning and periodic battery replacement.

Handling CDs

Handle discs by their edges to prevent fingerprints and scratches.

To remove stains or fingerprints from the surface of a disc use a soft, lint-free, dry cloth. Wipe in straight movements from the center of the disc to the outside. Do not use any chemical products; they can damage the disc.

Do not write on, or attach labels to the surface of the disc.

To minimize exposure to dust and dirt, replace discs in their cases after use. Store each disc in its case, out of direct sunlight, high temperatures, and humidity.



Cleaning the enclosure

Use only a cloth to clean the outside of your Acoustic Wave® music system. If necessary, you may use a soft-bristled attachment to gently vacuum the front of the unit.

Do not use any solvents, chemicals, or cleaning solutions containing alcohol, ammonia, or abrasives. Do not spray cleaners directly on the music system. Do not allow liquids to spill into any openings on the case.

If liquids get into the product, turn it off. Call Bose® Customer Service as soon as possible to arrange for service (see phone numbers on inside back cover).

Replacing batteries



WARNING: Keep the remote control battery away from children. It may cause a fire or chemical burn if mishandled. Do not recharge, disassemble, heat above 212°F (100°C), or incinerate. Dispose of used battery promptly. Replace only with a lithium CR2032 or DL2032 battery by Duracell, Eveready, Hitachi, Maxell, or Toshiba (available from most electronics stores).

Technical information

Dimensions

10.6"H x 18.1"W x 7.4"D (26.9 cm x 46.0 cm x 18.8 cm)

Product weight

14.5 lb (6.5 kg)

Power rating

USA/Canada: 120VAC, 50/60Hz

International: 220-240VAC, 50/60Hz

12-15VDC

Troubleshooting

<i>Problem</i>	<i>Solution</i>
No system operation	Make sure power cord is completely plugged into both the system and the wall outlet.
FM reception is poor	<ul style="list-style-type: none">• An external antenna may be needed. Call the customer service number inside the back cover.• If the external antenna is not connected, be sure the switch is selecting the telescoping antenna.
No remote control	<ul style="list-style-type: none">• If the system is on battery power, return to regular AC power.• Replace the remote control battery. Follow the battery replacement procedure on page 6.
Display does not light	Return to regular AC power or press any button to briefly light the display.
CD does not play	<ul style="list-style-type: none">• Make sure a CD is in the compartment, label side up.• Make sure the CD compartment is closed.• Clean the CD as described on page 16.
CD skips	If the unit is getting bumped, place it where it is less likely to be bumped or jolted.

Customer service

For additional help in solving problems, contact Bose Customer Service. See the inside back cover for office locations and phone numbers.

Limited warranty

The Bose® Acoustic Wave® music system is covered by a limited 1-year transferable warranty.

What is covered:

All parts defective in material or workmanship.

For how long:

One year from the purchase date.

What we will do:

We will, at our sole option, repair or replace any defective parts free of charge.

What you must do:

1. Call Bose Customer Service and ask for shipping instructions.
2. Properly pack the unit, if possible, in the original carton for shipping.

Other conditions:

This warranty is fully transferable for the one year period following purchase.

THE PROVISIONS OF THIS WARRANTY ARE IN LIEU OF ANY OTHER WARRANTY, WHETHER EXPRESS OR IMPLIED, WRITTEN OR ORAL, INCLUDING ANY WARRANTY OF MERCHANTABILITY OR FITNESS FOR A PARTICULAR PURPOSE. BOSE'S MAXIMUM LIABILITY SHALL NOT EXCEED THE ACTUAL PURCHASE PRICE PAID BY YOU FOR THE PRODUCT. IN NO EVENT SHALL BOSE BE LIABLE FOR SPECIAL, INCIDENTAL, CONSEQUENTIAL, OR INDIRECT DAMAGES.

This warranty does not cover a defect that has resulted from improper or unreasonable use or maintenance, accident, improper packing, or unauthorized tampering, alteration, or modification as determined solely by us. This warranty is void if the label bearing the serial number has been removed or defaced.



BOSE[®]
Better sound through research[®]

©2004 Bose Corporation
The Mountain, Framingham, MA 01701-9168 USA
268180-ENGvo AM Rev.00